



1004/2 Elizabeth Bay Road ELIZABETH BAY, NSW

1 bed | 1 bath | 1 car

R&W

On the 10th floor of the Gazebo building, this chic apartment enjoys an ideal west aspect with surreal sunsets to 180-degree city skyline views, this is modern resort-style living.

Highlights

- * Floor-to-ceiling glass for supreme views
- * Living opens to multiple balconies
- * Unique curved design allows North-South light

rwebay.com.au/5192655

Luke McDonnell 0418 844 110

Greg McKinley 0412 044 822

Proudly Richardson&Wrench

Richardson & Wrench Elizabeth Bay / Potts Point
02 8356 2700

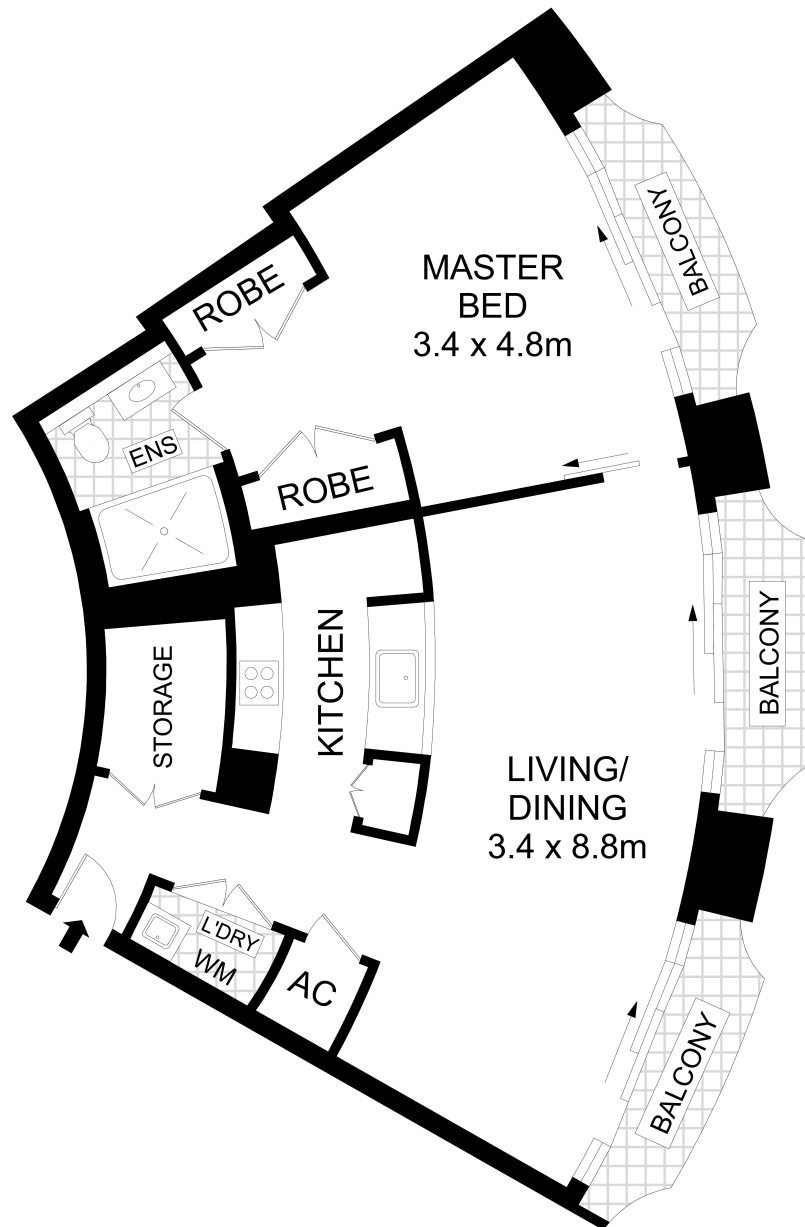
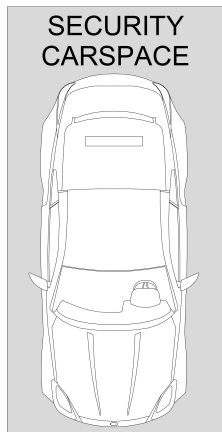

1004/2a Elizabeth Bay Road, Elizabeth Bay

Disclaimer

Floor Plan measurements are approximate and are for illustrative purposes only. While we cannot doubt the floor plans accuracy, we make no guarantee, warranty or representation as to the accuracy and completeness of the floor plan.

Every precaution has been taken to establish accuracy of the information in this brochure but does not constitute any representation by the vendor or agent.

R&W