



23/1 McDonald Street POTTS POINT, NSW

| 1 bath

R&W

Set in an elevated level three position facing North with expansive windows, this elegant apartment has a quiet, tree-house feel. With dark polished flooring and new quality blinds the living area includes a concealed bed with separate wardrobe. The bathroom features new tapware, vanity and frameless glass shower. The property overlooks a stunning pool, outdoor dining setting and manicured tropical grounds. The entire building has recently completed extensive upgrades with a large new lift, renovated lobby and breezy common walkways with city views.

[rwebay.com.au/5540439](https://www.rwebay.com.au/5540439)

Penny Timothy 0418 546 500

Luke McDonnell 0418 844 110

Proudly Richardson&Wrench

Richardson & Wrench Elizabeth Bay / Potts Point
02 8356 2700

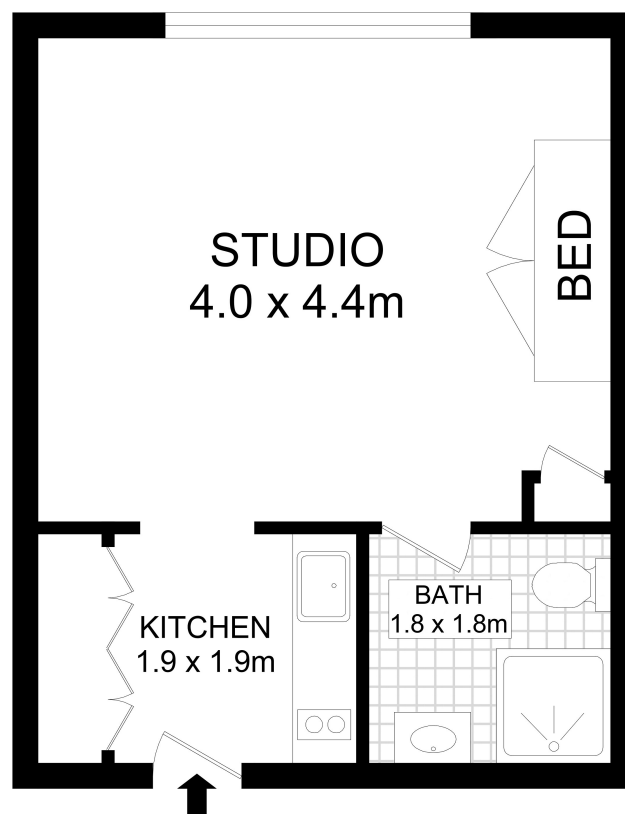

23/1 Macdonald Street, Potts Point

Disclaimer

Floor Plan measurements are approximate and are for illustrative purposes only. While we cannot doubt the floor plans accuracy, we make no guarantee, warranty or representation as to the accuracy and completeness of the floor plan.