



3/96 Elizabeth Bay Road ELIZABETH BAY, NSW

1 bed | 1 bath

R&W

- > Delightful leafy garden outlook, near level entry
- > Wide entry hall
- > Spacious living/dining room with original fireplace
- > Modern gas kitchen, full size refrigerator, washing machine
- > Luxurious bathroom with imported bath
- > King-size bedroom with generous b/in wardrobe
- > Study/guest bedroom overlooking garden
- > High ceilings, polished floorboards, white timber blinds
- > Easy access to residents' garden at rear and outside drying lines
- > Quiet & convenient location close to harbour foreshor...

rwebay.com.au/6406379

Penny Timothy 0418 546 500

Luke McDonnell 0418 844 110

Proudly Richardson&Wrench

Richardson & Wrench Elizabeth Bay / Potts Point
02 8356 2700

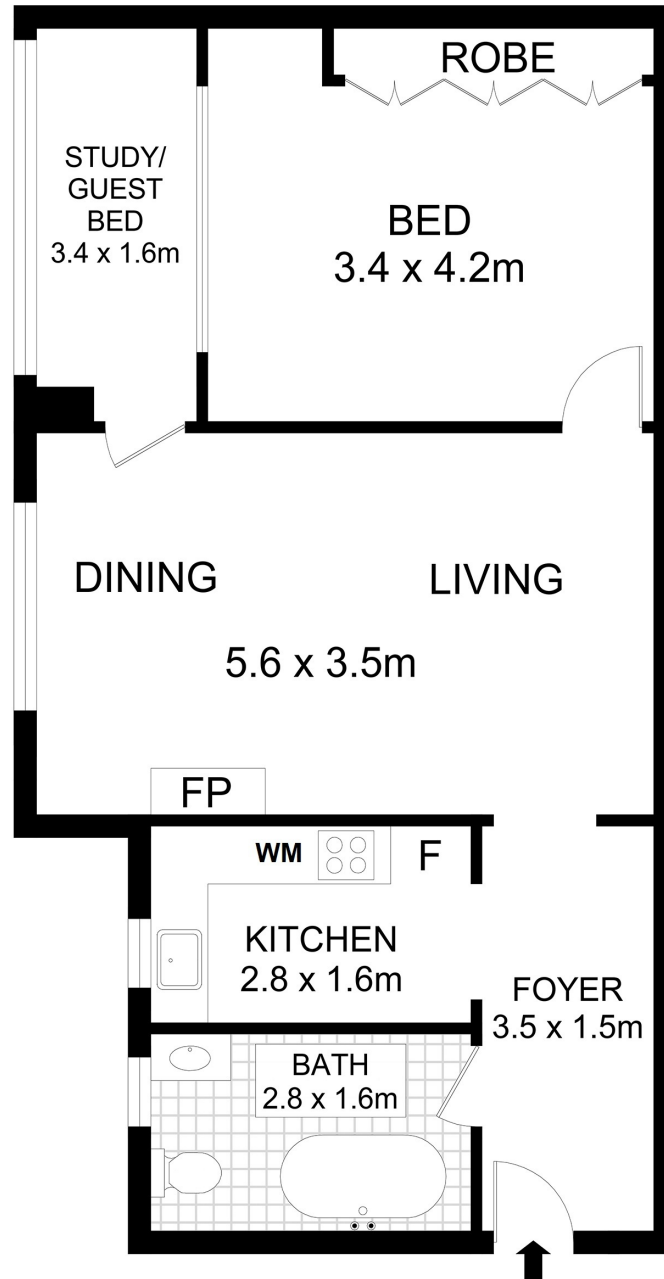
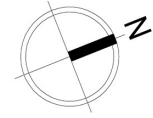

3/96 Elizabeth Bay Road, Elizabeth Bay

Disclaimer
Floor Plan measurements are approximate and are for illustrative purposes only. While we cannot doubt the floor plans accuracy, we make no guarantee, warranty or representation as to the accuracy and completeness of the floor plan

Every precaution has been taken to establish accuracy of the information in this brochure but does not constitute any representation by the vendor or agent.

