



## 360/6c Cowper Wharf Roadway Woolloomooloo, NSW

**R&W**

| 1 bath

Embrace waterfront living at its finest in this delightful studio apartment nestled within the iconic Finger Wharf, a heritage listed gem. Facing west, this apartment boasts a seamless blend of comfort and style, offering an expansive combined living and bedroom area, alongside a generously proportioned kitchen. Indulge in afternoon serenity as natural light floods the space, showcasing panoramic vistas of the marina, city skyline and Botanical gardens.

\*Expansive views of the marina, city and Botanical gardens

[rwebay.com.au/8106576](https://rwebay.com.au/8106576)

Angelo Bouras 0401 658 653

Thomas Arthurs 0414 026 412

**Proudly Richardson&Wrench**

Richardson & Wrench Elizabeth Bay / Potts Point  
02 8356 2700

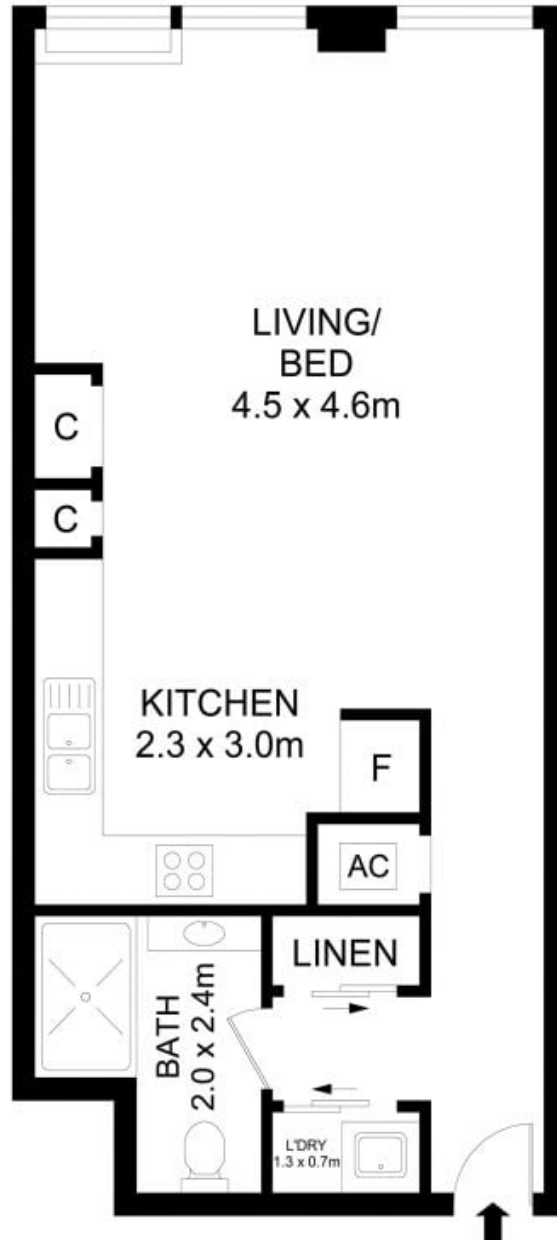
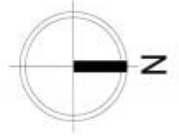

## 360/6 Cowper Wharf Roadway, Woolloomooloo

### Disclaimer

Floor Plan measurements are approximate and are for illustrative purposes only. While we cannot doubt the floor plans accuracy, we make no guarantee, warranty or representation as to the accuracy and completeness of the floor plan.

Every precaution has been taken to establish accuracy of the information in this brochure but does not constitute any representation by the vendor or agent.

