



## 68A Stephen Road Botany, NSW

6 bed | 2 bath | 3 car

- + Previously rented for \$3,200 per week, currently vacant
- + Each dwelling is fully self-contained
- + Hardwood timber flooring, stone benchtops
- + Ducted and split system a/c throughout
- + Large entertainers' balcony, wrap around courtyard and front yard
- + Lock up garage, ample storage throughout

In conjunction with Clay Chigwidden, Agents And Co Property Group, 0433 012 115

# R&W

Open Thursday, 19th September 2024 11:00 - 11:30

[rwebay.com.au/8120416](https://rwebay.com.au/8120416)

Angelo Bouras 0401 658 653

Thomas Arthurs 0414 026 412

**Proudly Richardson&Wrench**

Richardson & Wrench Elizabeth Bay / Potts Point  
02 8356 2700

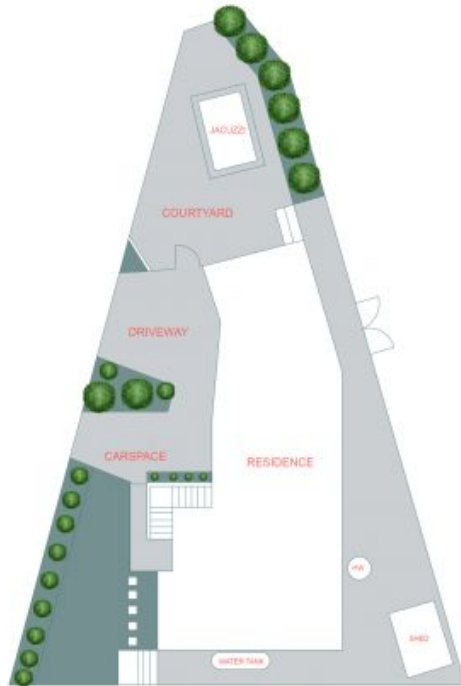

SITE PLAN



GROUND FLOOR



FIRST FLOOR

## 68a Stephen Road, Botany

Agents<sup>+CO</sup>

Scale in metres.

Indicative only. All information contained herein is obtained from sources we believe to be accurate. We cannot guarantee its accuracy. Interested persons should make and on their own enquires.

Every precaution has been taken to establish accuracy of the information in this brochure but does not constitute any representation by the vendor or agent.

**R&W**