



## 31/67 Macleay Street Potts Point, NSW

1 bed | 1 bath

Step out to Harbour Bridge and city skyline views from this top floor security apartment that features contemporary finishes. It offers a chic city fringe haven in a great location moments to the Woolloomooloo waterfront, village cafes, restaurants and nightlife.

Features Include:

- Light filled living area flows through to a main balcony
- Views of the city skyline including the Harbour Bridge
- Modern and well equipped galley-style kitchen

\*\*DISCLAIMER - Please be advised that this property has...

# R&W

Open Saturday, 16th November 2024 9:30 - 9:45

[rwebay.com.au/8174853](https://rwebay.com.au/8174853)

Reeve Smith 0450919965

R&W Leasing 02 8356 2700

**Proudly Richardson&Wrench**

Richardson & Wrench Elizabeth Bay / Potts Point  
02 8356 2700

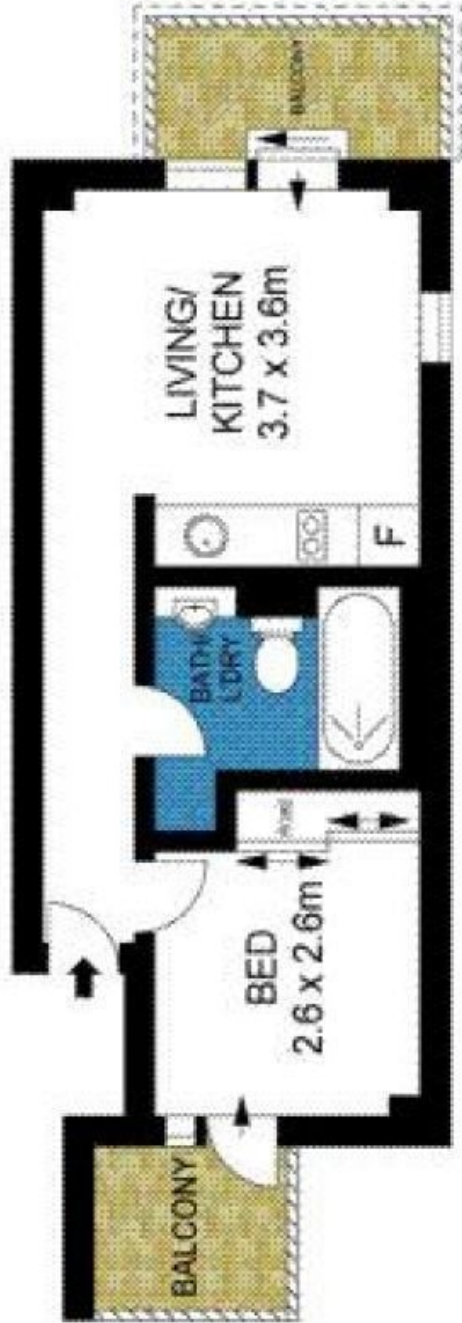

**LEVEL FIVE**

